

# DATA SHEET

DEHNCube Typ DCU 2 YPV 1100 2M 2S

GAK-S-1100-2x2R-X-Y-PC-1.0\_DEHNCube (900 923)

Art.No. 10017263

All values in [mm]  
Dimensions

„blue“

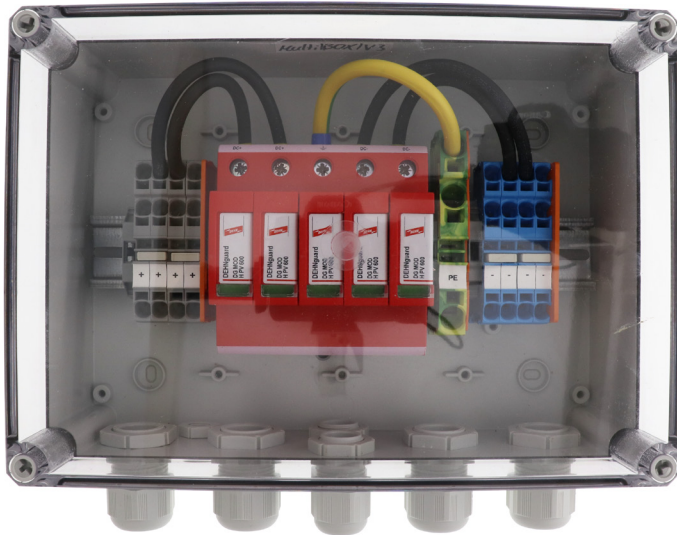

### Minimum Distances

|         |     |
|---------|-----|
| top     | 200 |
| bottom  | 200 |
| lateral | 100 |
| front   | 800 |

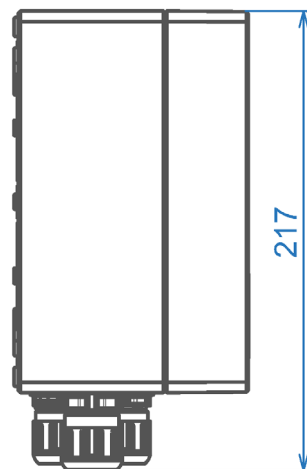
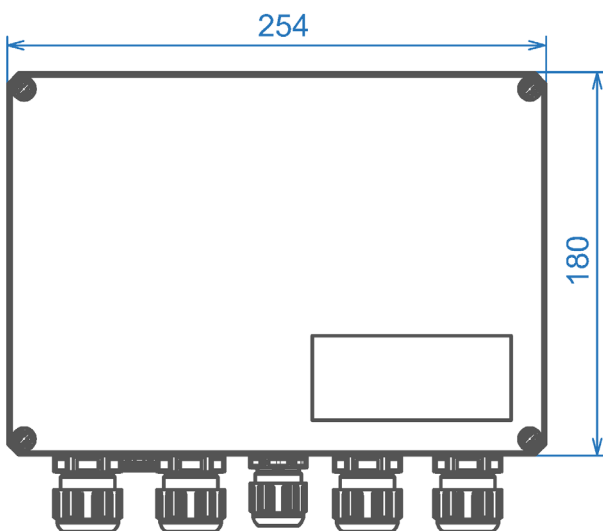
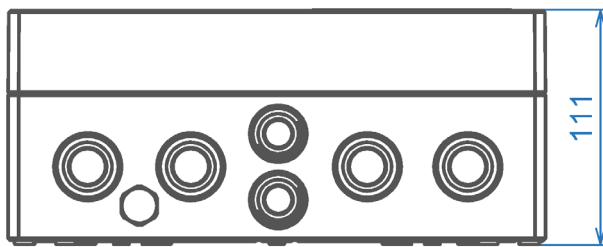

## TECHNICAL DATA

### NOMINAL VALUES

|  |       |      |
|--|-------|------|
| Rated insulation voltage $U_i$   | [VDC] | 1100 |
| Rated operating voltage $U_e$  | [VDC] | 1100 |
| Rated current $I_{nA}$ ( $= \sum I_{SC\ STC}$ )                        | [ADC] | 64   |
| Dimensioning value* $I_{SC\ MAX}$ ( $= \sum I_{SC\ STC} \times 1,25$ ) | [ADC] | 80   |
| Number of isolated MPP inputs  |       | 2    |
| Max. number of PV strings IN/OUT                                       |       | 4/2  |

### PER STRING

|  |       |    |
|--|-------|----|
| Rated current $I_{nc}$ ( $= I_{SC\ STC}$ )                             | [ADC] | 16 |
| Dimensioning value* $I_{SC\ MAX}$ ( $= \sum I_{SC\ STC} \times 1,25$ ) | [ADC] | 20 |

### OVERVOLTAGE PROTECTION

|   |       |      |
|---|-------|------|
| Test category acc. to EN 61643-11 (Type)      |       | II   |
| Max. permissible continuous voltage $U_{cpv}$ | [VDC] | 1100 |

### INPUT (TO THE PV-GENERATOR)

|                                     |                    |                             |
|-------------------------------------|--------------------|-----------------------------|
| <u>Cable entry</u>                  |                    |                             |
| Cable glands (EN 50262)             |                    | M25 with multiple seal (3x) |
| <u>Connections</u>                  |                    |                             |
| Connection type                     |                    | push-in cage clamp          |
| Stripping length                    | [mm]               | 12                          |
| <u>Wire cross-section (from-to)</u> |                    |                             |
| Cu-fine stranded                    | [mm <sup>2</sup> ] | 2,5 - 6                     |
| Cu-solid                            | [mm <sup>2</sup> ] | 2,5 - 6                     |

### OUTPUT (TO THE PV-INVERTER)

|                                     |                    |                            |
|-------------------------------------|--------------------|----------------------------|
| <u>Cable entry</u>                  |                    |                            |
| Cable glands (EN 50262)             |                    | M25 with multiple seal(3x) |
| <u>Connections</u>                  |                    |                            |
| Connection type                     |                    | push-in cage clamp         |
| Stripping length                    | [mm]               | 12                         |
| <u>Wire cross-section (from-to)</u> |                    |                            |
| Cu-fine stranded                    | [mm <sup>2</sup> ] | 2,5 - 6                    |
| Cu-solid                            | [mm <sup>2</sup> ] | 2,5 - 6                    |

### EARTH CONNECTION

|                         |                    |                    |
|-------------------------|--------------------|--------------------|
| <u>Cable entry</u>      |                    |                    |
| Cable glands (EN 50262) |                    | M20                |
| <u>Connections</u>      |                    |                    |
| Connection type         |                    | push-in cage clamp |
| Wire cross-section      | [mm <sup>2</sup> ] | 16                 |

### GENERAL DATA

|  |      |                 |
|--|------|-----------------|
| Dimensions WxHxD (without cable glands)      | [mm] | 254 x 180 x 111 |
| Weight, approx.                              | [kg] | 1,8             |
| Operating temperature range                  | [°C] | -25...+35       |
| Temperature - transport/storage              | [°C] | -25...+35       |
| Humidity - condensing allowed                |      | yes             |
| Humidity - permitted range                   | [%]  | 5...95          |
| Max. altitude above sea level                | [m]  | 2000            |
| Protection class IP (EN 60529)               |      | 65              |
| Outdoor suitability (protected area)         |      | yes             |
| Protection against electric shock (EN 61140) |      | II              |
| Enclosure material                           |      | polycarbonat    |
| RoHS-conformity (2011/65/EU)                 |      | yes             |
| Enclosure colour                             |      | RAL7035         |
| Cover  |      | transparent     |
| Mounting method                              |      | wall mounting   |
| Locking system                               |      | screw cover     |
| <u>MISCELLANEOUS</u>                         |      |                 |
| Customs tariff number                        |      | 85372091        |

\* the dimensioning value  $I_{SC\ MAX}$  acc. to VDE 0100-712:2016-10, implies the factor 1.25 for  $I_{SC\ STC}$  of the PV module, or of the PV string.